

BREAK - REFER TO 9002

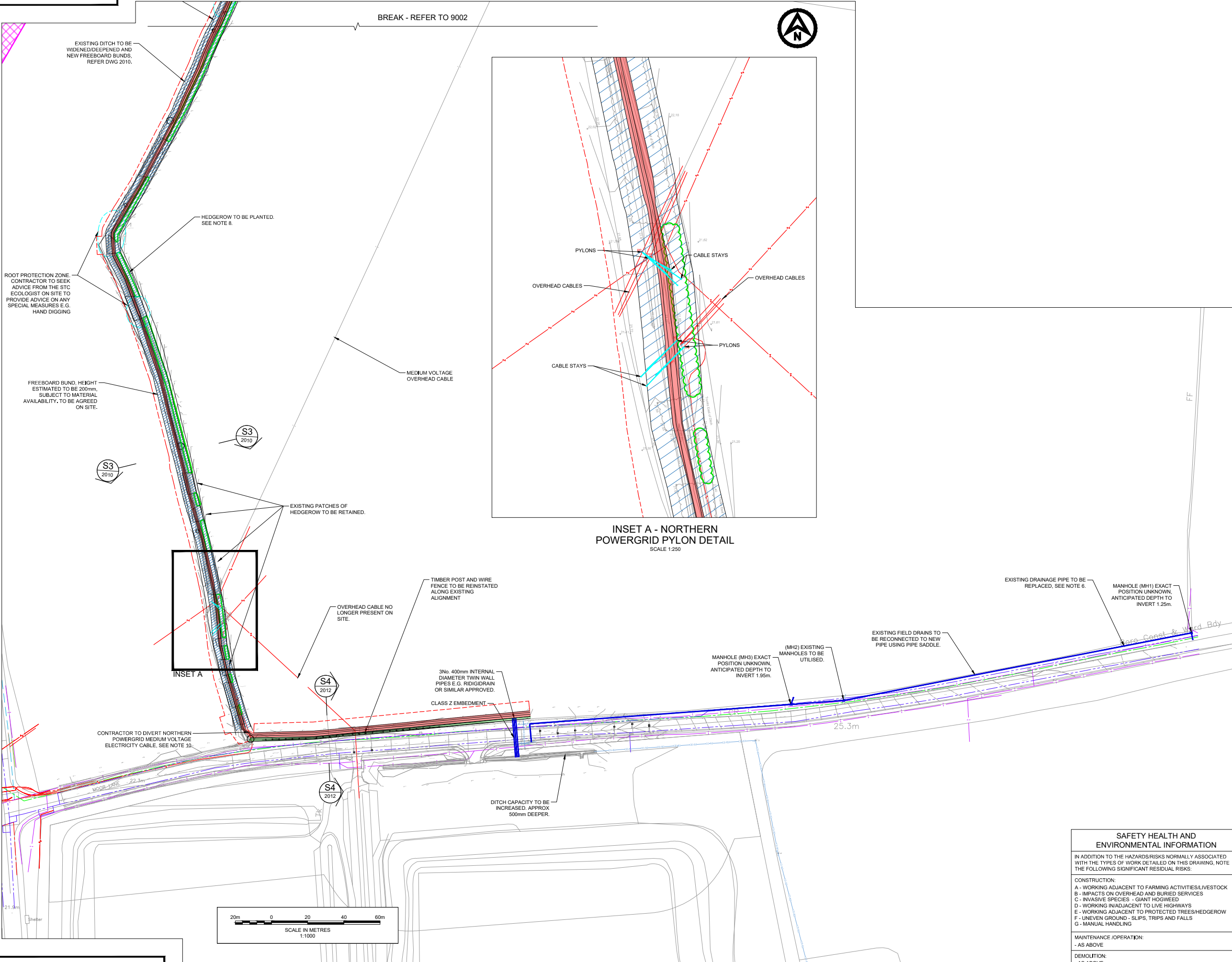

1. ALL DIMENSIONS ARE IN MILLIMETRES UNLESS NOTED OTHERWISE.
2. ALL LEVELS ARE IN METRES RELATIVE TO ORDNANCE DATUM (OD) UNLESS NOTED OTHERWISE.
3. ALL COORDINATES ARE IN METRES RELATIVE TO ORDNANCE SURVEY NATIONAL GRID.
4. ALL MATERIALS AND WORKMANSHIP WILL BE AS DEFINED IN THE SPECIFICATION UNLESS NOTED OTHERWISE.
5. DRAWING SHALL BE READ IN CONJUNCTION WITH CIVILS 3D MODEL FILE WHICH THE CONTRACTOR SHALL USE FOR SETTING OUT EARTHWORKS.
6. EXISTING 300mm VITRIFIED CLAY PIPE TO BE REPLACED WITH 300mm ID HDPE TWINWALL PIPE. PIPE IS TO BE LAID AT SAME FALL AS EXISTING PIPE, WITH CLASS S PIPE BEDDING (150mm MIN BEDDING AND SURROUND, REFER DWG - 3010 DETAIL A). CONTRACTOR TO CONNECT ANY DRAINS FROM FIELD TO NEW PIPE USING PIPE SADDLE. MIN NO OF FIELD DRAINS 2, OF VARYING SIZE (100-150mm).
7. UTILITIES INFORMATION TAKEN FROM STATUTORY UNDERTAKERS ENQUIRIES (MARCH 2020). LOCATIONS INDICATIVE ONLY. CONTRACTOR TO CONFIRM WITH APPROPRIATE INVESTIGATION.
8. HEDGEROW SHALL BE IN ACCORDANCE WITH BS4428:1989 AND PLANTING MIX SHALL COMPRISE 80% HAWTHORN & BLACKTHORN PLUS ALL OF THE FOLLOWING SPECIES:
 - CRAB APPLE
 - GUELDER ROSE
 - BIRD CHERRY
 - HAZEL
 - ROWAN
9. EXTENT OF HEDGEROW AND WOODLAND/TREE ROOT PROTECTION AREA PRESENTED ON DRAWING IS SHOWN AS PER ATCA REPORT (OCTOBER 2019) BY ALL ABOUT TREES. REFER TO REPORT FOR FURTHER DETAILS.
10. EXISTING BURIED MEDIUM VOLTAGE ELECTRICITY CABLE TO BE DIVERTED/INSTALLED TO A DEPTH OF APPROXIMATELY 1m BENEATH INVERT OF NEW DITCH, REFER NORTHERN POWERGRID ENQUIRY NO. ENG5445643 TECHNICAL SPECIFICATION AND DETAILED ESTIMATE.

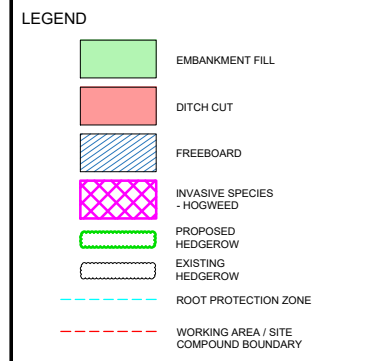
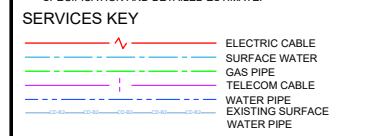

NOT FOR CONSTRUCTION

PO1	02-06-20	FOR PUBLIC CONSULTATION	CC	MP	MD
REV	DATE	DESCRIPTION	BY	CHK	APP

REVISIONS



PROJECT
CLEADON
FLOOD ALLEVIATION SCHEME

TITLE
PUBLIC CONSULTATION
SUNDERLAND ROAD -
GENERAL ARRANGEMENT
SHEET 2 OF 2



DRAWN	CC	CHECKED	MP	APPROVED	MD
DATE	JUNE 2020	SCALE	AT A1 AS SHOWN	REF.	PC1168

DRAWING No.	PC1168-RHD-51-XX-DR-C-9003	REVISION	P01
-------------	----------------------------	----------	-----

SAFETY HEALTH AND ENVIRONMENTAL INFORMATION

IN ADDITION TO THE HAZARDS/RISKS NORMALLY ASSOCIATED WITH THE TYPES OF WORK DETAILED ON THIS DRAWING, NOTE THE FOLLOWING SIGNIFICANT RESIDUAL RISKS:

CONSTRUCTION:

- A - WORKING ADJACENT TO FARMING ACTIVITIES/LIVESTOCK
- B - IMPACTS ON OVERHEAD AND BURIED SERVICES
- C - INVASIVE SPECIES - GIANT HOGWEED
- D - WORKING IN ADJACENT TO LIVE HIGHWAYS
- E - WORKING ADJACENT TO PROTECTED TREES/HEDGEROW
- F - UNEVEN GROUND - SLIPS, TRIPS AND FALLS
- G - MANUAL HANDLING

MAINTENANCE / OPERATION:

- AS ABOVE

DENOLITION:

- AS ABOVE

